









## Postazioni Esterne audio-video Audio-video outdoor stations

		Descrizione Description	Info	€	<input type="checkbox"/>	<input type="checkbox"/>	513
			<b>VIIP-PE1</b> Postazione esterna audio/video monofamiliare realizzata in monoblocco per installazione a incasso oppure ad appoggio parete. Alimentazione tramite switch PoE 48Vdc o alimentatore switching 24Vdc. Lettore di card MIFARE® integrato, illuminazione cartellini con led bianco con intensità variabile in funzione della luminosità ambientale, n.1 relè di apertura varco in "potenza" con ingresso per l'installazione di un pulsante ausiliario, n.1 relè di apertura varco con contatto normalmente aperto. Ingresso sensore "porta aperta". Dimensioni (LxHxP) 100x215x45,7 mm. <i>Single-call audio/video outdoor station created as a monobloc for recessed or wall-mounted installation. Power supply by switch PoE 48Vdc or switching 24Vdc. Integrated MIFARE® card reader, name tag lighting with white LEDs with variable intensity according to the ambient brightness, 1 "power" entry point opening relay with input for installation of an auxiliary button, no.1 entry point opening relay with normally open contact. "Door open" sensor input. Dimensions (LxHxD) 100x215x45,7 mm.</i>	1	1		
			<b>VIIP-PE2</b> Postazione esterna audio/video bifamiliare. Caratteristiche tecniche comuni alla postazione esterna VIIP-PE1. <i>Two-call audio/video outdoor station. Technical characteristics common to the VI2F-PE1 outdoor station.</i>	1	1		
			<b>VIIP-PE4</b> Postazione esterna audio/video quadrifamiliare. Caratteristiche tecniche comuni alla postazione esterna VIIP-PE1 tranne che per l'assenza del lettore di card MIFARE®. <i>Four-call audio/video outdoor station. Technical characteristics common to the VI2F-PE1 outdoor station except for the absence of the MIFARE® card reader.</i>	1	1		
<p><b>DISPOSITIVO NON COMPATIBILE CON IL SISTEMA VIDEOCITOFONICO DOMINA SMART</b> DEVICE NOT COMPATIBLE WITH THE IP DOMINA SMART VIDEO INTERCOM SYSTEM</p>			<b>VI-VTRPE1</b> Vetrino di ricambio per postazione esterna audio/video monofamiliare Vlx-PE1. <i>Spare glass for Vlx-PE1 one-family audio/video external unit.</i>	1	1		
			<b>VI-VTRPE2</b> Vetrino di ricambio per postazione esterna audio/video bifamiliare Vlx-PE2. <i>Spare glass for Vlx-PE2 two-family audio/video external unit.</i>	1	1		
			<b>VI-VTRPE4</b> Vetrino di ricambio per postazione esterna audio/video quadrifamiliare Vlx-PE4. <i>Spare glass for Vlx-PE2 four-call audio/video external unit.</i>	1	1		

### Esempio installativo Installation example

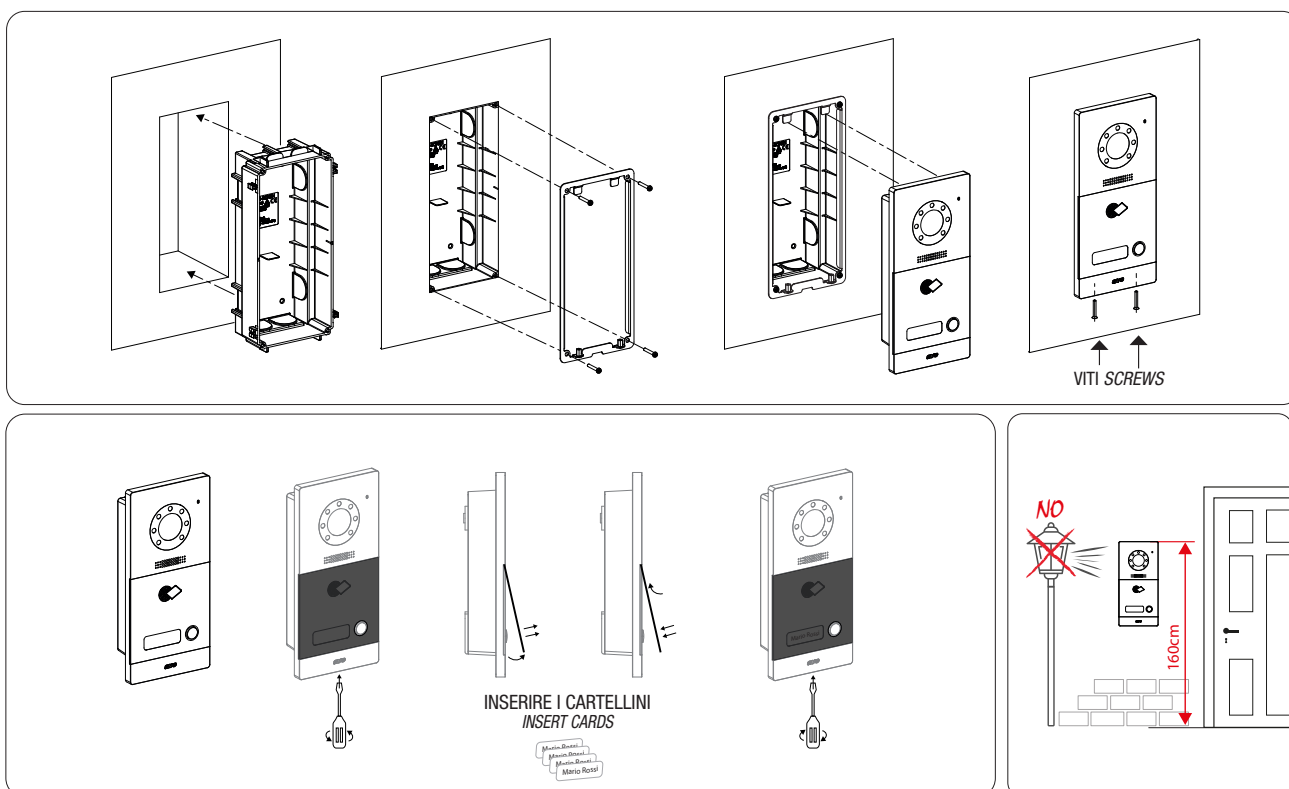

Le dimensioni, salvo diversamente specificato, sono in mm  
Dimensions, except where otherwise specified, are in mm

Prodotto per Export For Export only

Imballo Minimo pcs Min. Packaging pcs

Imballo Standard pcs Std. Packaging pcs